

DATA SHEET

PART NUMBER ESOMVR10 / ESOMVR30

MODEL DESCRIPTION

Residual Current Device (RCD) 230-240Va.c. 20 Amp 10mA or 30mA

Circuit ID

Provision to mount circuit identification label complete with clear and coloured polycarbonate clip-in labels as standard

All labels are 18mm x 9mm and can contain up to three lines of laser engraved 1.9mm high text, maximum 10 characters per line, Arial narrow font style – upon request

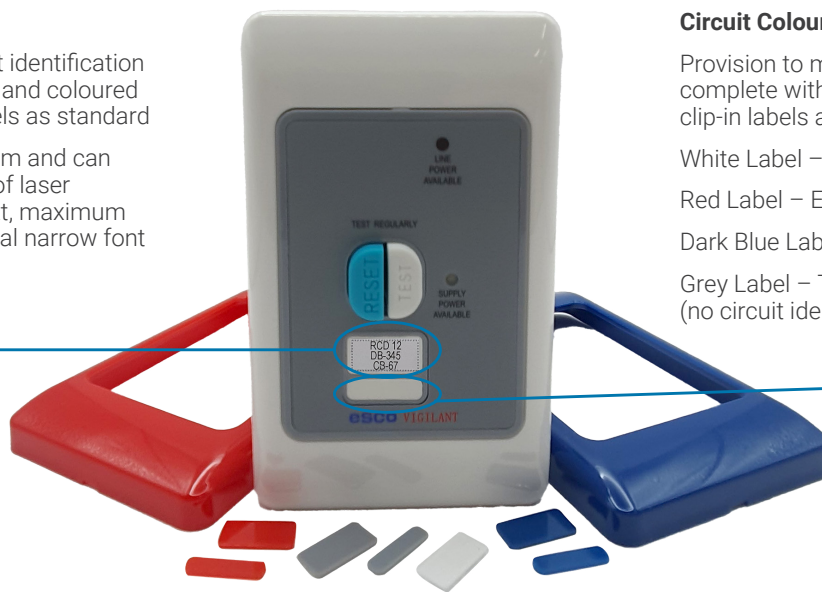

Circuit Colour

Provision to mount circuit colour label complete with coloured polycarbonate clip-in labels as standard:

- White Label – Non-Essential circuit
- Red Label – Essential circuit
- Dark Blue Label – UPS circuit
- Grey Label – To blank off this provision (no circuit identification)



TECHNICAL DATA

PART NUMBER	ESOMVR10 / ESOMVR30	MAX TRIPPING CURRENT	10mA or 30mA
DESCRIPTION	RCD 230-240Va.c. 20 Amp 10mA or 30mA	RCD TYPE	10mA - Type I / 30mA - Type II
ORIENTATION	Vertical	WITHSTAND RATING	3KA Circuit Protection by MCB or HRC Fuse 20A max
SUPPLY VOLTAGE	230-240Va.c.	COLOUR	Universal - White (WH), Red (RD), Dark Blue (DB)
FREQUENCY	50Hz	MOUNTING CENTRES	84mm
POLES DESCRIPTION	Double Pole	COMPLIANCE	AS/NZS 3190, AS/NZS 3003, ISO 22196
MAX CURRENT	20A		

PART NUMBER
ESOMHR10 / ESOMHR30

MODEL DESCRIPTION

Residual Current Device (RCD) 230-240Va.c. 20 Amp 10mA or 30mA



Circuit ID

Provision to mount circuit identification label complete with clear and coloured polycarbonate clip-in labels as standard

All labels are 18mm x 9mm and can contain up to three lines of laser engraved 1.9mm high text, maximum 10 characters per line, Arial narrow font style – upon request



Circuit Colour

Provision to mount circuit colour label complete with coloured polycarbonate clip-in labels as standard:

- White Label – Non-Essential circuit
- Red Label – Essential circuit
- Dark Blue Label – UPS circuit
- Grey Label – To blank off this provision (no circuit identification)



TECHNICAL DATA

PART NUMBER	ESOMHR10 / ESOMHR30	MAX TRIPPING CURRENT	10mA or 30mA
DESCRIPTION	RCD 230-240Va.c. 20 Amp 10mA or 30mA	RCD TYPE	10mA - Type I / 30mA - Type II
ORIENTATION	Horizontal	WITHSTAND RATING	3KA Circuit Protection by MCB or HRC Fuse 20A max
SUPPLY VOLTAGE	230-240Va.c.	COLOUR	Universal - White (WH), Red (RD), Dark Blue (DB)
FREQUENCY	50Hz	MOUNTING CENTRES	84mm
POLES DESCRIPTION	Double Pole	COMPLIANCE	AS/NZS 3190, AS/NZS 3003, ISO 22196
MAX CURRENT	20A		



AUSTRALIA
 89 Egerton St (Cnr Fariola & Egerton)
 PO Box 6193, Silverwater
 NSW 2128 AUSTRALIA

T 1300 879 363 F 1300 879 364
 customer.service@escoindustries.com.au
 www.escoindustries.com.au

NEW ZEALAND
 Unit 11/273 Neilson St, Onehunga
 AUCKLAND 1061 NEW ZEALAND

D +64 9 526 1880 Freecall 0800 663 367
 customer.service@escoindustries.co.nz
 www.escoindustries.co.nz

PART NUMBER

ESOM2R10, ESOM2R30

PART NUMBER:
 ESOM2R

10mA OR 30mA	COLOUR
10 = 10mA	WH = White
30 = 30mA	RD = Red
	DB = Dark Blue

MODEL DESCRIPTION

Socket Outlets Switched 10 Amp 250Va.c. with Residual Current Device (RCD) 230-240Va.c. 20 Amp 10mA or 30mA



ESOM2R10WH



ESOM2R10RD



ESOM2R10DB

TECHNICAL DATA

PART NUMBER	ESOM2R10, ESOM2R30	MAXIMUM TRIPPING CURRENT	RCD - 10mA or 30mA
DESCRIPTION	Socket Outlets Switched 10 Amp 250Va.c. with RCD 230-240Va.c. 20 Amp 10mA or 30mA	RCD TYPE	10mA - Type I / 30mA - Type II
ORIENTATION	Horizontal	WITHSTAND RATING	3KA Circuit Protection by MCB or HRC Fuse 20A max
SUPPLY VOLTAGE	RCD - 230-240Va.c. / Socket Outlets - 250Va.c.	COLOUR	White (WH), Red (RD), Dark Blue (DB)
FREQUENCY	RCD - 50Hz	MOUNTING CENTRES	84mm
POLES DESCRIPTION	RCD - Double Pole / Socket Outlets - Single Pole	COMPLIANCE	AS/NZS 3190, AS/NZS 3003, AS/NZS 3112, ISO 22196
MAXIMUM CURRENT	RCD - 20A / Socket Outlets - 10A		



AUSTRALIA
 89 Egerton St (Cnr Fariola & Egerton)
 PO Box 6193, Silverwater
 NSW 2128 AUSTRALIA

T 1300 879 363 F 1300 879 364
 customer.service@escoindustries.com.au
 www.escoindustries.com.au

NEW ZEALAND
 Unit 11/273 Neilson St, Onehunga
 AUCKLAND 1061 NEW ZEALAND

D +64 9 526 1880 **Freecall** 0800 663 367
 customer.service@escoindustries.co.nz
 www.escoindustries.co.nz

PART NUMBER

ESOM2RC10BE

MODEL DESCRIPTION

Socket Outlets Switched 10 Amp 250Va.c. with Residual Current Device (RCD) 230-240Va.c. 20 Amp Type 1 10mA, marked "CLEANING PURPOSES ONLY"



ESOM2RC10BE

TECHNICAL DATA

PART NUMBER	ESOM2RC10BE	MAXIMUM TRIPPING CURRENT	RCD - 10mA
DESCRIPTION	Socket Outlets Switched 10 Amp 250Va.c. with RCD 230-240Va.c. 20 Amp Type 1 10mA, marked "CLEANING PURPOSES ONLY"	RCD TYPE	Type I RCD
ORIENTATION	Horizontal	WITHSTAND RATING	3KA Circuit Protection by MCB or HRC Fuse 20A max
SUPPLY VOLTAGE	RCD - 230-240Va.c. / Socket Outlets - 250Va.c.	COLOUR	Beige (BE) (cleaning purposes only)
FREQUENCY	RCD - 50Hz	MOUNTING CENTRES	84mm
POLES DESCRIPTION	RCD - Double Pole / Socket Outlets - Single Pole	COMPLIANCE	AS/NZS 3190, AS/NZS 3003, AS/NZS 3112, ISO 22196
MAXIMUM CURRENT	RCD - 20A / Socket Outlets - 10A		

PART NUMBER

ESOM2VR10WH / ESOM2VR30WH

MODEL DESCRIPTION

Socket Outlets Switched 10 Amp 250Va.c. with Residual Current Device (RCD) 230-240Va.c. 20 Amp 10mA or 30mA



ESOM2VR10WH

TECHNICAL DATA

PART NUMBER	ESOM2VR10WH / ESOM2VR30WH	MAXIMUM TRIPPING CURRENT	RCD - 10mA or 30mA
DESCRIPTION	Socket Outlets Switched 10 Amp 250Va.c. with RCD 230-240Va.c. 20 Amp 10mA or 30mA	RCD TYPE	10mA - Type I / 30mA - Type II
ORIENTATION	Vertical	WITHSTAND RATING	3KA Circuit Protection by MCB or HRC Fuse 20A max
SUPPLY VOLTAGE	RCD - 230-240Va.c. / Socket Outlets - 250Va.c.	COLOUR	White (WH)
FREQUENCY	RCD - 50Hz	MOUNTING CENTRES	84mm
POLES DESCRIPTION	RCD - Double Pole / Socket Outlets - Single Pole	COMPLIANCE	AS/NZS 3190, AS/NZS 3003, AS/NZS 3112, ISO 22196
MAXIMUM CURRENT	RCD - 20A / Socket Outlets - 10A		